

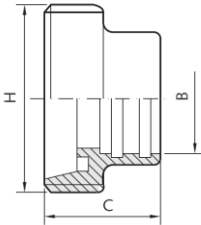

DIN 11851

Bocchettone DIN femmina – Expanding male part DIN

|  |  | Codice - Code | DN mm | H mm | B mm | C mm | Kg |
|---|---|---------------|-------|------|------|------|------|
| | | RRDINFFIL010 | 10 | 28 | 12,2 | 12 | 0,07 |
| RRDINFFIL015 | 15 | 34 | 18,2 | 18 | 0,08 | | |
| RRDINFFIL020 | 20 | 44 | 22,2 | 22 | 0,11 | | |
| RRDINFFIL030 | 25 | 52 | 28,2 | 29 | 0,13 | | |
| RRDINFFIL040 | 32 | 58 | 34,2 | 32 | 0,16 | | |
| RRDINFFIL050 | 40 | 65 | 40,2 | 33 | 0,22 | | |
| RRDINFFIL060 | 50 | 78 | 52,2 | 35 | 0,30 | | |
| RRDINFFIL070 | 60 | 85 | 60,3 | 37 | 0,35 | | |
| RRDINFFIL080 | 65 | 95 | 70,3 | 40 | 0,42 | | |
| RRDINFFIL090 | 80 | 110 | 85,3 | 45 | 0,60 | | |
| RRDINFFIL100 | 100 | 130 | 101,9 | 54 | 1,00 | | |
| RRDINFFIL100+ | 100 | 130 | 104,3 | 54 | 1,00 | | |

Bocchettone DIN maschio – liner expanding DIN

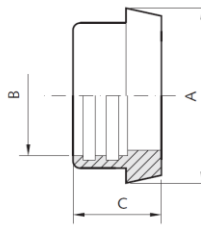
|  |  | Codice - Code | DN mm | A mm | B mm | C mm | Kg |
|---|---|---------------|-------|------|------|------|------|
| | | RRDINMFIL010 | 10 | 22 | 12,2 | 17 | 0,06 |
| RRDINMFIL015 | 15 | 28 | 18,2 | 17 | 0,07 | | |
| RRDINMFIL020 | 20 | 36 | 22,2 | 18 | 0,08 | | |
| RRDINMFIL025 | 25 | 44 | 28,2 | 22 | 0,09 | | |
| RRDINMFIL032 | 32 | 50 | 34,2 | 25 | 0,12 | | |
| RRDINMFIL040 | 40 | 56 | 40,2 | 26 | 0,15 | | |
| RRDINMFIL050 | 50 | 68 | 52,2 | 28 | 0,21 | | |
| RRDINMFIL060 | 60 | 76 | 60,3 | 30 | 0,26 | | |
| RRDINMFIL065 | 65 | 86 | 70,3 | 32 | 0,32 | | |
| RRDINMFIL080 | 80 | 100 | 85,3 | 37 | 0,41 | | |
| RRDINMFIL100 | 100 | 121 | 101,9 | 44 | 0,80 | | |
| RRDINMFIL100+ | 100 | 121 | 104,3 | 44 | 0,80 | | |

Girella DIN – Nut DIN

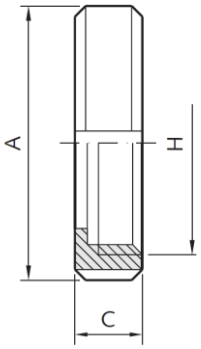
|  |  | Codice - Code | DN mm | H mm | A mm | C mm | Kg |
|---|---|---------------|-------|------|------|------|------|
| | | RRDINGIR010 | 10 | 28 | 38 | 18 | 0,08 |
| RRDINGIR015 | 15 | 34 | 44 | 18 | 0,10 | | |
| RRDINGIR020 | 20 | 44 | 54 | 20 | 0,15 | | |
| RRDINGIR025 | 25 | 52 | 63 | 21 | 0,18 | | |
| RRDINGIR032 | 32 | 58 | 70 | 21 | 0,22 | | |
| RRDINGIR040 | 40 | 65 | 78 | 21 | 0,24 | | |
| RRDINGIR050 | 50 | 78 | 92 | 22 | 0,36 | | |
| RRDINGIR060 | 60 | 85 | 99 | 22 | 0,45 | | |
| RRDINGIR065 | 65 | 95 | 112 | 25 | 0,58 | | |
| RRDINGIR080 | 80 | 110 | 127 | 29 | 0,83 | | |
| RRDINGIR090 | 90 | 120 | 138 | 30 | 0,93 | | |
| RRDINGIR100 | 100 | 130 | 148 | 31 | 1,02 | | |
| RRDINGIR125 | 125 | 160 | 178 | 34 | 1,50 | | |
| RRDINGIR150 | 150 | 190 | 210 | 40 | 2,00 | | |

Guarnizione per raccordo DIN – pipe fitting's gasket DIN

| Codice - Code | DN mm | A mm | B mm | C mm |
|---------------|-------|------|------|------|
| | | | | |
| RRDINGUA010 | 10 | 20 | 12 | 4,5 |
| RRDINGUA015 | 15 | 26 | 18 | 4,5 |
| RRDINGUA020 | 20 | 33 | 23 | 4,5 |
| RRDINGUA025 | 25 | 40 | 30 | 5 |
| RRDINGUA032 | 32 | 46 | 36 | 5 |
| RRDINGUA040 | 40 | 52 | 42 | 5 |
| RRDINGUA050 | 50 | 64 | 54 | 5 |
| RRDINGUA060 | 60 | 72 | 62 | 5 |
| RRDINGUA065 | 65 | 81 | 71 | 5 |
| RRDINGUA080 | 80 | 95 | 85 | 5 |
| RRDINGUA090 | 90 | 102 | 92 | 6 |
| RRDINGUA100 | 100 | 114 | 104 | 6 |
| RRDINGUA150 | 150 | 167 | 155 | 7 |

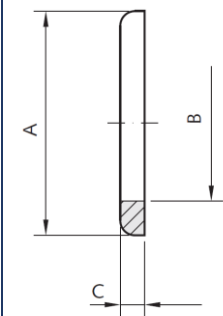

Tappo di chiusura DIN – taper blank DIN

| Codice - Code | DN mm | A mm | B mm | C mm | Kg |
|---------------|-------|------|------|------|------|
| | | | | | |
| RRDINTAP010 | 10 | 22 | 18 | 9 | 0,30 |
| RRDINTAP015 | 15 | 28 | 24 | 9 | 0,40 |
| RRDINTAP020 | 20 | 36 | 30 | 11 | 0,90 |
| RRDINTAP025 | 25 | 44 | 35 | 13 | 0,14 |
| RRDINTAP032 | 32 | 50 | 41 | 13 | 0,18 |
| RRDINTAP040 | 40 | 56 | 48 | 13 | 0,23 |
| RRDINTAP050 | 50 | 68 | 61 | 14 | 0,38 |
| RRDINTAP060 | 60 | 76 | 69 | 15 | 0,45 |
| RRDINTAP065 | 65 | 86 | 79 | 16 | 0,70 |
| RRDINTAP080 | 80 | 100 | 93 | 16 | 0,97 |
| RRDINTAP100 | 100 | 121 | 114 | 20 | 1,80 |
| RRDINTAP125 | 125 | 150 | 137 | 22 | 2,30 |
| RRDINTAP150 | 150 | 176 | 163 | 24 | 3,10 |

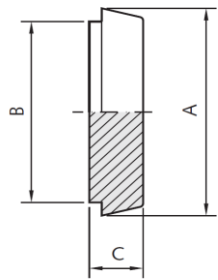

Bocchettone DIN femmina a saldare “medio” – welding male “normal type” DIN

| Codice - Code | DN mm | H mm | F mm | D mm | C mm | Kg |
|---------------|-------|------|------|------|------|------|
| | | | | | | |
| RRDINFSL010 | 10 | 28 | 15 | 10 | 21 | 0,07 |
| RRDINFSL015 | 15 | 34 | 21 | 16 | 21 | 0,08 |
| RRDINFSL020 | 20 | 44 | 25 | 20 | 24 | 0,10 |
| RRDINFSL025 | 25 | 52 | 31 | 26 | 29 | 0,12 |
| RRDINFSL032 | 32 | 58 | 37 | 32 | 32 | 0,14 |
| RRDINFSL040 | 40 | 65 | 43 | 38 | 33 | 0,19 |
| RRDINFSL050 | 50 | 78 | 55 | 50 | 35 | 0,26 |
| RRDINFSL060 | 60 | 85 | 64 | 58 | 37 | 0,29 |
| RRDINFSL065 | 65 | 95 | 72 | 66 | 40 | 0,37 |
| RRDINFSL080 | 80 | 110 | 87 | 81 | 45 | 0,60 |
| RRDINFSL100 | 100 | 130 | 106 | 98 | 54 | 0,78 |

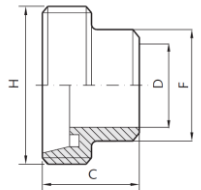

Bocchettone DIN femmina a saldare "grosso spessore" – welding male "high thickness" DIN

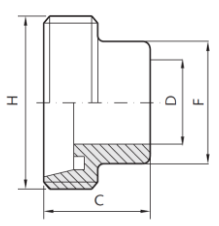
|  |  | Codice – Code | DN mm | H mm | F mm | D mm | C mm | Kg |
|---|---|---------------|-------|------|------|------|------|------|
| | | RRDINFSLSP010 | 10 | 28 | 18 | 10 | 21 | 0,05 |
| RRDINFSLSP015 | 15 | 34 | 24 | 16 | 21 | 0,08 | | |
| RRDINFSLSP020 | 20 | 44 | 29 | 20 | 24 | 0,11 | | |
| RRDINFSLSP025 | 25 | 52 | 35 | 26 | 29 | 0,13 | | |
| RRDINFSLSP032 | 32 | 58 | 41 | 32 | 32 | 0,16 | | |
| RRDINFSLSP040 | 40 | 65 | 48 | 38 | 33 | 0,22 | | |
| RRDINFSLSP050 | 50 | 78 | 61 | 50 | 35 | 0,32 | | |
| RRDINFSLSP060 | 60 | 85 | 68 | 58 | 37 | 0,35 | | |
| RRDINFSLSP065 | 65 | 95 | 79 | 66 | 40 | 0,42 | | |
| RRDINFSLSP080 | 80 | 110 | 93 | 81 | 45 | 0,60 | | |
| RRDINFSLSP100 | 100 | 130 | 114 | 100 | 54 | 1,00 | | |

Bocchettone DIN femmina a saldare BW – welding male part DIN

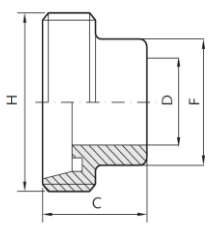
|  |  | Codice - Code | DN mm | H mm | F mm | D mm | C mm | Kg |
|--|--|---------------|-------|------|------|------|------|------|
| | | RRDINFBW010 | 10 | 28 | 12 | 9 | 21 | 0,06 |
| RRDINFBW015 | 15 | 34 | 18 | 15 | 21 | 0,07 | | |
| RRDINFBW020 | 20 | 44 | 22 | 19 | 24 | 0,09 | | |
| RRDINFBW025 | 25 | 52 | 28 | 25 | 29 | 0,11 | | |
| RRDINFBW032 | 32 | 58 | 34 | 31 | 32 | 0,12 | | |
| RRDINFBW040 | 40 | 65 | 40 | 37 | 33 | 0,17 | | |
| RRDINFBW050 | 50 | 78 | 52 | 49 | 35 | 0,25 | | |
| RRDINFBW065 | 65 | 95 | 70 | 66 | 40 | 0,35 | | |
| RRDINFBW080 | 80 | 110 | 85 | 81 | 45 | 0,55 | | |
| RRDINFBW100 | 100 | 130 | 101,6 | 97,6 | 54 | 0,75 | | |
| RRDINFBW100+ | 100 | 130 | 104 | 100 | 54 | 0,75 | | |
| RRDINFBW125 | 125 | 160 | 129 | 125 | 56 | 1,00 | | |
| RRDINFBW150 | 150 | 190 | 154 | 150 | 60 | 1,00 | | |

Bocchettone DIN maschio a saldare "medio" – welding normal liner DIN

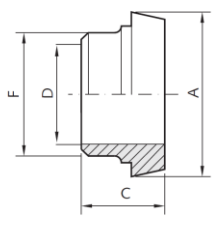
|  |  | Codice - Code | DN mm | F mm | D mm | A mm | C mm | Kg |
|---|---|---------------|-------|------|------|------|------|------|
| | | RRDINMSL010 | 10 | 15 | 10 | 22 | 17 | 0,06 |
| RRDINMSL015 | 15 | 21 | 16 | 28 | 17 | 0,07 | | |
| RRDINMSL020 | 20 | 25 | 20 | 36 | 18 | 0,08 | | |
| RRDINMSL025 | 25 | 31 | 26 | 44 | 22 | 0,09 | | |
| RRDINMSL032 | 32 | 37 | 32 | 50 | 25 | 0,11 | | |
| RRDINMSL040 | 40 | 43 | 38 | 56 | 26 | 0,14 | | |
| RRDINMSL050 | 50 | 55 | 50 | 68 | 28 | 0,18 | | |
| RRDINMSL060 | 60 | 64 | 58 | 76 | 30 | 0,22 | | |
| RRDINMSL065 | 65 | 72 | 66 | 86 | 32 | 0,30 | | |
| RRDINMSL080 | 80 | 87 | 81 | 100 | 37 | 0,41 | | |
| RRDINMSL100 | 100 | 106 | 98 | 121 | 44 | 0,75 | | |

Bocchettone DIN maschio a saldare grosso spessore – welding high thickness liner DIN

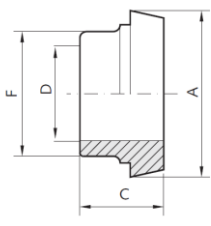
|  |  | Codice - Code | DN mm | F mm | D mm | A mm | C mm | Kg |
|---|---|---------------|-------|------|------|------|------|------|
| | | RRDINMSLSP010 | 10 | 18 | 9 | 22 | 17 | 0,04 |
| RRDINMSLSP015 | 15 | 24 | 15 | 28 | 17 | 0,06 | | |
| RRDINMSLSP020 | 20 | 29 | 20 | 36 | 18 | 0,08 | | |
| RRDINMSLSP025 | 25 | 35 | 26 | 44 | 22 | 0,09 | | |
| RRDINMSLSP032 | 32 | 41 | 32 | 50 | 25 | 0,12 | | |
| RRDINMSLSP040 | 40 | 48 | 38 | 56 | 26 | 0,15 | | |
| RRDINMSLSP050 | 50 | 61 | 50 | 68 | 28 | 0,21 | | |
| RRDINMSLSP060 | 60 | 68 | 58 | 76 | 30 | 0,30 | | |
| RRDINMSLSP065 | 65 | 79 | 66 | 86 | 32 | 0,32 | | |
| RRDINMSLSP080 | 80 | 93 | 81 | 100 | 37 | 0,41 | | |
| RRDINMSLSP100 | 100 | 114 | 98 | 121 | 44 | 0,80 | | |

Bocchettone DIN maschio a saldare BW – welding thin liner DIN

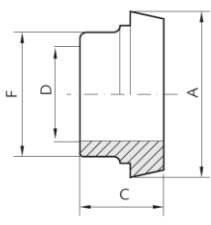
|  |  | Codice - Code | DN mm | F mm | D mm | A mm | C mm | Kg |
|--|--|---------------|-------|------|------|------|------|------|
| | | RRDINMBW010 | 10 | 12 | 9 | 22 | 17 | 0,06 |
| RRDINMBW015 | 15 | 18 | 15 | 28 | 17 | 0,03 | | |
| RRDINMBW020 | 20 | 22 | 19 | 36 | 18 | 0,08 | | |
| RRDINMBW025 | 25 | 28 | 25 | 44 | 22 | 0,09 | | |
| RRDINMBW032 | 32 | 34 | 31 | 50 | 25 | 0,10 | | |
| RRDINMBW040 | 40 | 40 | 37 | 56 | 26 | 0,14 | | |
| RRDINMBW050 | 50 | 52 | 49 | 68 | 28 | 0,17 | | |
| RRDINMBW065 | 65 | 70 | 66 | 86 | 32 | 0,30 | | |
| RRDINMBW080 | 80 | 85 | 81 | 100 | 37 | 0,40 | | |
| RRDINMBW100 | 100 | 101,6 | 97,6 | 121 | 44 | 0,75 | | |
| RRDINMBW100+ | 100 | 104 | 100 | 121 | 44 | 0,75 | | |
| RRDINMBW125 | 125 | 129 | 125 | 150 | 34 | 1,00 | | |
| RRDINMBW150 | 150 | 154 | 150 | 176 | 37 | 1,00 | | |

Girella cieca DIN nuda – end cap DIN

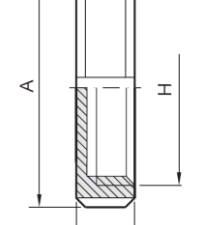
|  |  | Codice - Code | DN mm | H mm | A mm | C mm | Kg |
|---|---|---------------|-------|------|------|------|------|
| | | RRDINGIRC010 | 10 | 28 | 38 | 18 | 0,10 |
| RRDINGIRC015 | 15 | 34 | 44 | 18 | 0,12 | | |
| RRDINGIRC020 | 20 | 44 | 54 | 21 | 0,18 | | |
| RRDINGIRC025 | 25 | 52 | 63 | 21 | 0,20 | | |
| RRDINGIRC032 | 32 | 58 | 70 | 21 | 0,25 | | |
| RRDINGIRC040 | 40 | 65 | 78 | 21 | 0,29 | | |
| RRDINGIRC050 | 50 | 78 | 92 | 22 | 0,37 | | |
| RRDINGIRC060 | 60 | 85 | 99 | 22 | 0,50 | | |
| RRDINGIRC065 | 65 | 95 | 112 | 25 | 0,70 | | |
| RRDINGIRC080 | 80 | 110 | 127 | 29 | 0,95 | | |
| RRDINGIRC100 | 100 | 130 | 148 | 31 | 1,40 | | |

Girella cieca DIN con catenella – end cap with chain DIN

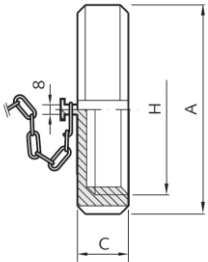
|  |  | Codice - Code | DN mm | H mm | A mm | C mm | Kg |
|---|---|---------------|-------|------|------|------|------|
| | | RRDINGIRCC015 | 15 | 34 | 44 | 18 | 0,12 |
| RRDINGIRCC020 | 20 | 44 | 54 | 21 | 0,18 | | |
| RRDINGIRCC025 | 25 | 52 | 63 | 21 | 0,20 | | |
| RRDINGIRCC032 | 32 | 58 | 70 | 21 | 0,25 | | |
| RRDINGIRCC040 | 40 | 65 | 78 | 21 | 0,29 | | |
| RRDINGIRCC050 | 50 | 78 | 92 | 22 | 0,37 | | |
| RRDINGIRCC060 | 60 | 85 | 99 | 22 | 0,50 | | |
| RRDINGIRCC065 | 65 | 95 | 112 | 25 | 0,70 | | |
| RRDINGIRCC080 | 80 | 110 | 127 | 29 | 0,95 | | |
| RRDINGIRCC100 | 100 | 130 | 148 | 31 | 1,40 | | |
| RRDINGIRCC125 | 125 | 160 | 178 | 34 | 2,00 | | |

Curva 90° con raccordi DIN femmina – DIN maschio/girello – 90° expanding bend male-female DIN ends

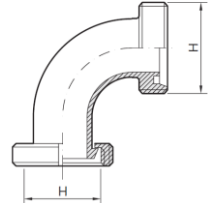
|  |  | Codice - Code | DN mm | H mm | Kg |
|--|--|---------------|-------|------|------|
| | | RRDINCU025 | 25 | 52 | 0,50 |
| RRDINCU032 | 32 | 58 | 0,65 | | |
| RRDINCU040 | 40 | 65 | 0,80 | | |
| RRDINCU050 | 50 | 78 | 1,10 | | |
| RRDINCU065 | 65 | 95 | 1,80 | | |
| RRDINCU080 | 80 | 110 | 2,50 | | |
| RRDINCU100 | 100 | 130 | 4,00 | | |

Bocchettone DIN maschio con portagomma – liner hose holder DIN

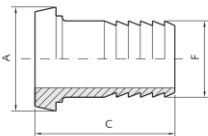
|  |  | Codice - Code | DN mm | A mm | F mm | C mm | Kg |
|---|---|---------------|-------|------|------|------|------|
| | | RRDINPORTM020 | 20 | 36 | 25 | 66 | 0,16 |
| RRDINPORTM025 | 25 | 44 | 30 | 72 | 0,18 | | |
| RRDINPORTM032 | 32 | 50 | 35 | 82 | 0,25 | | |
| RRDINPORTM040 | 40 | 56 | 40 | 86 | 0,30 | | |
| RRDINPORTM050 | 50 | 58 | 52 | 93 | 0,45 | | |
| RRDINPORTM060 | 60 | 76 | 60 | 102 | 0,55 | | |
| RRDINPORTM065 | 65 | 86 | 70 | 109 | 0,65 | | |
| RRDINPORTM080 | 80 | 100 | 80 | 117 | 0,80 | | |
| RRDINPORTM100 | 100 | 121 | 100 | 130 | 1,50 | | |

Bocchettone DIN femmina con portagomma – male part hose holder DIN

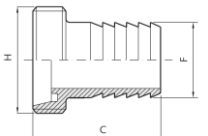
|  |  | Codice - Code | DN mm | F mm | H mm | C mm | Kg |
|---|---|---------------|-------|------|------|------|------|
| | | RRDINPORTF020 | 20 | 25 | 44 | 72 | 0,18 |
| RRDINPORTF025 | 25 | 30 | 52 | 79 | 0,20 | | |
| RRDINPORTF032 | 32 | 35 | 58 | 89 | 0,28 | | |
| RRDINPORTF040 | 40 | 40 | 65 | 93 | 0,35 | | |
| RRDINPORTF050 | 50 | 52 | 78 | 100 | 0,50 | | |
| RRDINPORTF060 | 60 | 60 | 85 | 110 | 0,65 | | |
| RRDINPORTF065 | 65 | 70 | 95 | 117 | 0,75 | | |
| RRDINPORTF080 | 80 | 80 | 110 | 125 | 1,00 | | |
| RRDINPORTF100 | 100 | 100 | 130 | 140 | 1,20 | | |