

FDPM Series - Clamping and braking element with integrated springs

Braking element with high clamping force.
Material and shape of contact parts allow high clamping force without damaging the rail.

FDPM#--- M
FDPM#--- D



Guide size **25 ÷ 35 mm**
Working type **Norm. Closed**
Body **Steel**
Operating Temperature **-20°C ÷ 80°C**
Operating Pressure **5,5 ÷ 8 bar**
Switching time **40 ÷ 60 mSec**
Contact parts Hardness **60 ÷ 62 HRC**

- Locking element without the use of energy
- High clamping force thanks to a double piston system
- Short reaction times
- Compact and rigid body
- Clamping in case of pressure drop
- Working in emergency stop

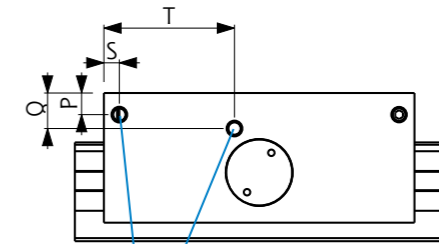
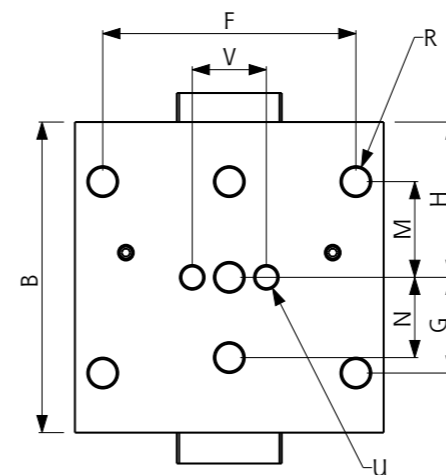
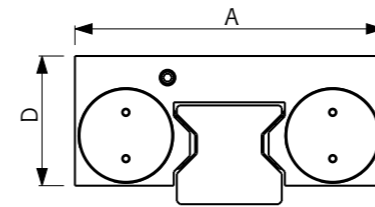

M5
AIR CONNECTION
we recommend
the use of compressed
air hose \varnothing 6x4

Type	Size	Clamping Force [N]		A [mm]	B [mm]	D [mm]	F [mm]	G [mm]	H [mm]	M [mm]	N [mm]	P [mm]	Q [mm]	R	S [mm]	T [mm]	U	V [mm]
		M	D															
FDPM	25 S	1500	3900	70	99	32.5	57	22.5	49.5	22.5	20	7.75	5.25	M8x7	5	56	M6x7	20
FDPM	25 T	1500	3900	72	99	32.5	57	22.5	49.5	22.5	20	7.75	7.75	M8x7	5	43	M6x7	20
FDPM	30 S	2100	5600	87	99	38	72	26	49.5	26	22	9	5	M10x8	5	42	M8x8	22
FDPM	30 T	2100	5600	90	99	38	72	26	49.5	26	22	9	5	M10x8	5	42	M8x8	22
FDPM	35 S	2600	6600	100	100.6	42	82	31	50.3	31	26	7	11.5	M10x10	5	42.3	M8x10	24
FDPM	35 T	2600	6600	108	100.6	42	82	31	50.3	31	26	7	11.5	M10x10	5	42.3	M8x10	24