

FDPH Series - Powered double piston element

New line created to have a high clamping force in small spaces.
 Powered Dual Locking Action: with a pair of pistons for each tightening part.
 The clamping force of this element is double that of F line.

FDPH##--- S
 FDPH##--- E

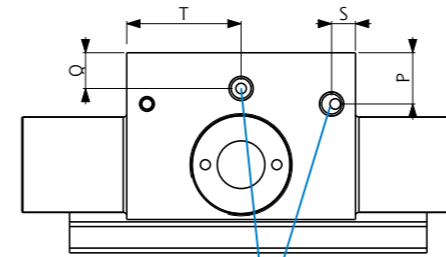
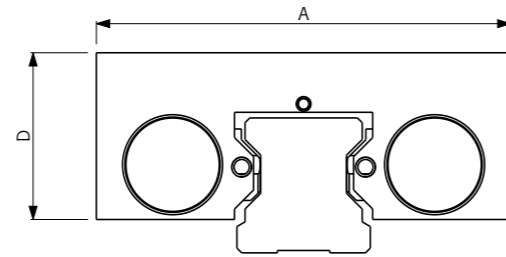

M5 AIR CONNECTION
 we recommend the use of compressed air hose \varnothing 6x4

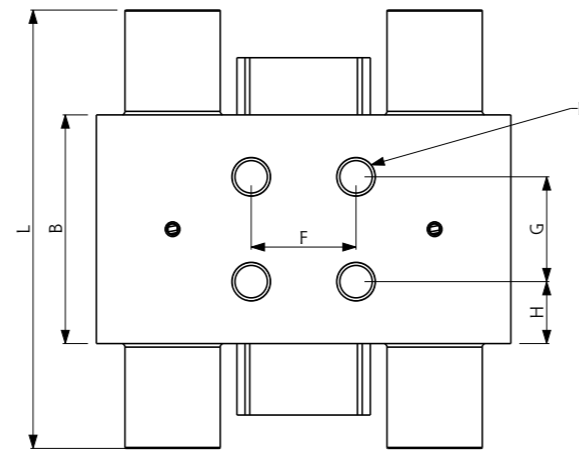

FDPH##\$ M
 FDPH##\$ D



Guide size **15 ÷ 55 mm**
 Working type **Norm. Open**
 Body **Steel**
 Operating Temperature **-20°C ÷ +80°C**
 Operating Pressure **5,5 ÷ 8 bar**
 Switching time **40 ÷ 60 mSec**
 Contact parts Hardness **60 ÷ 62 HRC**

- ◆ Dual piston system: high clamping force
- ◆ Small size
- ◆ Short reaction time.

Guide size **15 ÷ 55 mm**
 Working type **Norm. Closed**
 Body **Steel**
 Operating Temperature **-20°C ÷ +80°C**
 Operating Pressure **5,5 ÷ 8 bar**
 Switching time **40 ÷ 60 mSec**
 Contact parts Hardness **60 ÷ 62 HRC**

- ◆ Locking element without the use of energy
- ◆ High clamping force thanks to a double piston system
- ◆ Small size
- ◆ Short reaction times.

Type	Size	Clamping Force [N]			D	A [mm]	B [mm]	D [mm]	F [mm]	G [mm]	H [mm]	L [mm]	P [mm]	Q [mm]	R	S [mm]	T [mm]
		M	S	E													
FDPH	15 S	800	1300	1300	2100	61	56	21.5	15	15	20.5	94	5	5	M4x4	16.2	16.2
FDPH	15 T	800	1300	1300	2100	61	56	21.5	15	15	20.5	94	5	5.2	M4x4	17	17
FDPH	20 S	1200	2000	2000	3200	70	51	27	20	27	12	95	6.5	6.5	M5x6	16.1	15.8
FDPH	20 T	1200	2000	2000	3200	73	51	25.5	20	27	12	95	5	5	M5x6	16.1	15.8
FDPH	25 S	1500	2400	2400	3900	75	51	32.5	20	20	15.5	100	5	7.25	M6x7	25.5	5
FDPH	25 T	1500	2400	2400	3900	78	51	32.5	20	20	15.5	100	5	7.25	M6x7	20.5	5
FDPH	30 S	2100	3500	3500	5600	90	50	38	22	22	14	108	9	5	M8x10	12	25
FDPH	30 T	2100	3500	3500	5600	93	50	38	22	22	14	108	9	5	M8x10	20.5	5
FDPHL	35 S	2100	3500	3500	5600	97	50	40	24	24	13	108	11	8	M8x15	25	12
FDPH	35 S	2500	4000	4000	6500	101	57.6	42	24	24	16.8	97/6	10.5	6.5	M8x15	28.8	5
FDPHH	35 S	3000	4600	4600	7600	106	57.6	43.5	24	24	16.8	121.6	10.5	6.5	M8x15	28.8	6
FDPH	35 T	2500	4000	4000	6500	109	60.8	42.3	24	24	18.4	124.6	7	5	M8x16	30.4	5
FDPH	45 S	3000	4600	4600	7600	120	60.8	55	26	26	17.4	124.8	12	7	M10x18	30.4	5
FDPH	45 T	3000	4600	4600	7600	120	60.8	49.3	26	26	17.4	124.8	12.3	7	M10x19	30.4	5
FDPH	55 S	4000	6000	6000	10000	128	60	59	30	30	15	126	18	8	M10x20	30	23.5
FDPH	55 T	4000	6000	6000	10000	136	60	54	30	30	15	126	13	8	M10x20	27	23.5